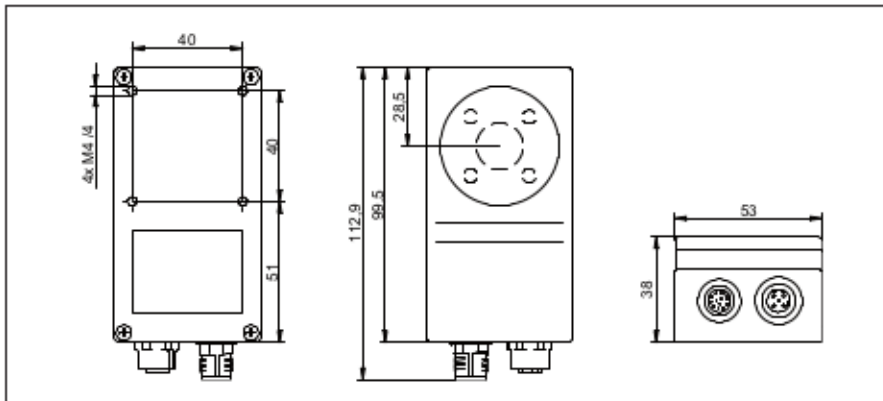

VeriSens® CS-100
VS CS100M03I16EP

Article no.: 11093026

Dimension drawing

General data

| | |
|---------------------------|--|
| Resolution, Sensor type | 752 × 480 px, 1/3" CMOS (monochrome) |
| LED illumination | Infrared, LED class: free group (risk-free, EN 62471:2008) |
| Speed | |
| High Resolution Mode: | Max. 50 inspections per second |
| Lens | 16 mm |
| Min. object distance | 70 mm |
| Number of jobs (products) | Up to 255 |
| Features per job | 32 |
| Fault image memory | 32 |
| Signal processing | Baumer <i>FEX</i> ® 3.5 |

Electrical data

| | |
|-------------------|---|
| Power supply | == +18 ... 30 VDC |
| Power consumption | Typical 5W (I _{max} = 1 A at 24 V) |
| Inputs | 8 ... 30 VDC |
| Outputs | PNP 100 mA |
| Digital input | Trigger, Job selection, external Teach-in, Encoder (CH-A, CH-B) 500 kHz |
| Digital output | Pass / Fail 1-5, Flash Sync, Alarm, Camera Ready, Output Enable |
| Communication | |
| Setup | Ethernet (10 Base-T / 100 Base-TX) |
| Process interface | - |
| Visualization | Web interface |

Mechanical data

| | |
|------------------------|--|
| Width × Height × Depth | 53 mm × 99.5 mm × 38 mm |
| Material | Housing: Aluminum, Cover glass: PMMA ¹⁾ |
| Weight | 250 g |

¹⁾ integrated daylight filter

Operating conditions

| | |
|-----------------------------|-------------------------------|
| Operating temperature | +5 ... 50 °C |
| Humidity | 0 ... 90 % (non-condensing) |
| Protection class | IP 67 |
| Vibration load | IEC 60068-2-6, IEC 60068-2-64 |
| Mechanical shock resistance | EN 60068-2-27 |

Photo

Connection (on device)

Electrical connection M12 / 12-pin



| | |
|--------------------|----------|
| 1: PWR (18-30 VDC) | 7: OUT3 |
| 2: Ground | 8: IN3 |
| 3: IN1 (Trigger) | 9: OUT4 |
| 4: OUT1 | 10: IN4 |
| 5: IN2 | 11: IN5 |
| 6: OUT2 | 12: OUT5 |

Ethernet interface M12 / 4-pin



| | |
|--------|--------|
| 1: TD+ | 3: TD- |
| 2: RD+ | 4: RD- |

