



1 inch MEGAPIXEL Machine Vision Lens

MPZ Series

- Compact & Lightweight
- Shorter Working Distance
- Floating Design
- Nominal Distortion Design
- Ensure Corner Brightness
- Vibration Resistance : 5G



IMX183
1" 2.4 μ m

IMX255
1" 3.45 μ m

IMX267/305
1" 3.45 μ m

EV2S12M
1" 2.8 μ m

XGS12000
1" 3.2 μ m

CMV4000
1" 5.5 μ m

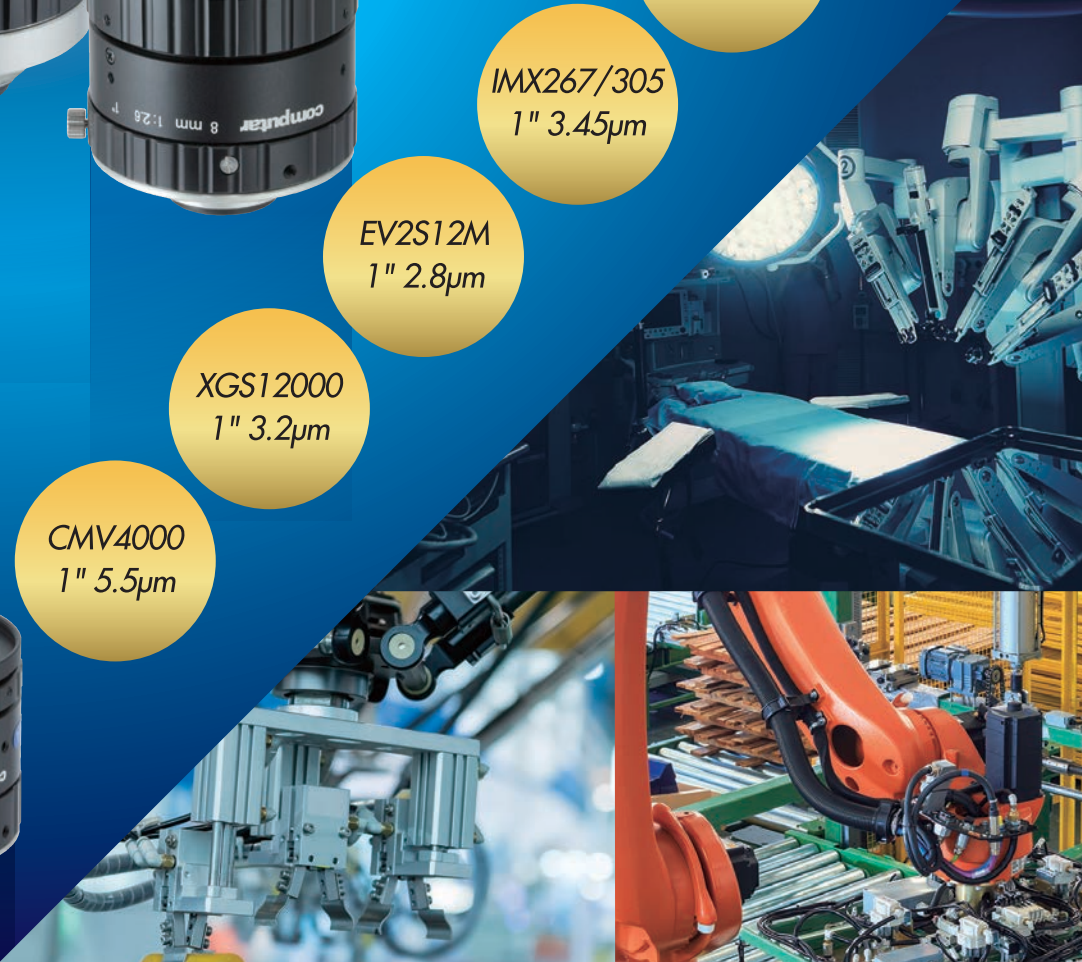

V0826-MPZ

Focal Length	8mm		Distortion	1 Type	-0.8%
Max. Aperture Ratio	1:2.6		Distortion	2/3 Type	-2.1%
Max. Image Format	12.8mm x 9.6mm(φ16mm)		Distortion	1/1.8 Type	-1.9%
Operation Range	Iris	F2.6 - F16.0	Filter Size	M82 P=0.75mm ※	
	Focus	0.1m - Inf.	Weight	203.1g	
Angle of View	D	88.8°	2/3 Type	68.6°	58.2°
	H	76.9°		57.1°	47.8°
	V	61.5°		44.2°	36.6°
Operation Temperature	-10°C - +50°C		※ When using ZM-0810 (Sold separately)		

Dimensions

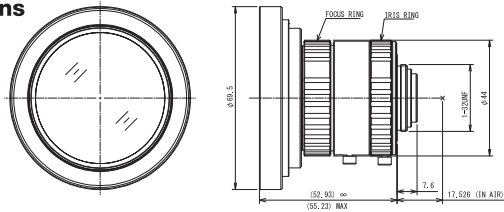

V1226-MPZ

Focal Length	12mm		Distortion	1 Type	0.0%*
Max. Aperture Ratio	1:2.6		Distortion	2/3 Type	-1.1%
Max. Image Format	12.8mm x 9.6mm(φ16mm)		Distortion	1/1.8 Type	-1.0%
Operation Range	Iris	F2.6 - F16.0	Filter Size	M37.5 P=0.5mm	
	Focus	0.1m - Inf.	Weight	98.4g	
Angle of View	D	67.4°	2/3 Type	49.8°	41.5°
	H	56.7°		40.7°	33.7°
	V	44.1°		31.0°	25.5°
Operation Temperature	-10°C - +50°C				

Dimensions

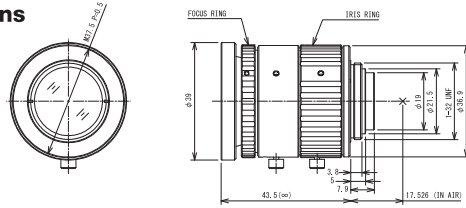

V1624-MPZ

Focal Length	16mm		Distortion	1 Type	0.0%*
Max. Aperture Ratio	1:2.4		Distortion	2/3 Type	-0.4%
Max. Image Format	12.8mm x 9.6mm(φ16mm)		Distortion	1/1.8 Type	-0.4%
Operation Range	Iris	F2.4 - F16.0	Filter Size	M33.5 P=0.5mm	
	Focus	0.1m - Inf.	Weight	108.1g	
Angle of View	D	53.2°	2/3 Type	38.1°	31.6°
	H	43.8°		30.9°	25.5°
	V	33.6°		23.4°	19.2°
Operation Temperature	-10°C - +50°C				

Dimensions

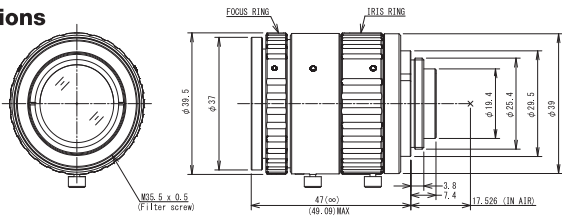

V2520-MPZ

Focal Length	25mm		Distortion	1 Type	0.0%*
Max. Aperture Ratio	1:2.0		Distortion	2/3 Type	0.0%*
Max. Image Format	12.8mm x 9.6mm(φ16mm)		Distortion	1/1.8 Type	0.0%*
Operation Range	Iris	F2.0 - F16.0	Filter Size	M35.5 P=0.5mm	
	Focus	0.15m - Inf.	Weight	73.1g	
Angle of View	D	35.5°	2/3 Type	24.9°	20.5°
	H	28.8°		20.0°	16.4°
	V	21.8°		15.1°	12.4°
Operation Temperature	-10°C - +50°C				

Dimensions

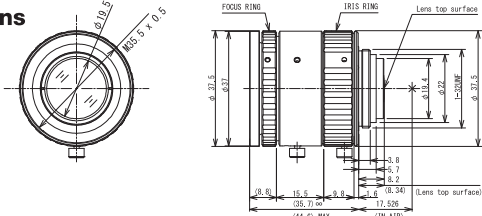

V3522-MPZ

Focal Length	35mm		Distortion	1 Type	0.0%*
Max. Aperture Ratio	1:2.2		Distortion	2/3 Type	0.0%*
Max. Image Format	12.8mm x 9.6mm(φ16mm)		Distortion	1/1.8 Type	0.0%*
Operation Range	Iris	F2.2 - F16.0	Filter Size	M34 P=0.5mm	
	Focus	0.2m - Inf.	Weight	118.2g	
Angle of View	D	25.8°	2/3 Type	17.9°	14.7°
	H	20.8°		14.4°	11.8°
	V	15.7°		10.8°	8.9°
Operation Temperature	-10°C - +50°C				

Dimensions

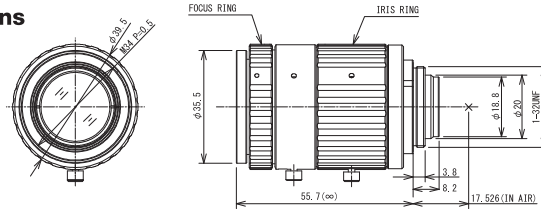

V5024-MPZ

Focal Length	50mm		Distortion	1 Type	0.0%*
Max. Aperture Ratio	1:2.4		Distortion	2/3 Type	0.0%*
Max. Image Format	12.8mm x 9.6mm(φ16mm)		Distortion	1/1.8 Type	0.0%*
Operation Range	Iris	F2.4 - F16.0	Filter Size	M30.5 P=0.5mm	
	Focus	0.2m - Inf.	Weight	138.5g	
Angle of View	D	18.2°	2/3 Type	12.6°	10.3°
	H	14.6°		10.1°	8.3°
	V	11.0°		7.6°	6.2°
Operation Temperature	-10°C - +50°C				

Dimensions

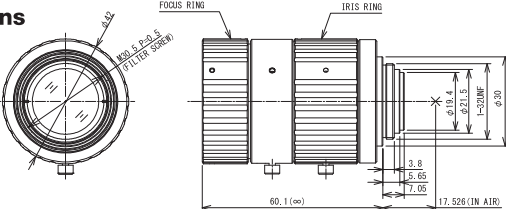

V7531-MPZ

Focal Length	75mm		Distortion	1 Type	0.0%*
Max. Aperture Ratio	1:3.1		Distortion	2/3 Type	0.0%*
Max. Image Format	12.8mm x 9.6mm(φ16mm)		Distortion	1/1.8 Type	0.0%*
Operation Range	Iris	F3.1 - F16.0	Filter Size	M30.5 P=0.5mm	
	Focus	0.25m - Inf.	Weight	176.1g	
Angle of View	D	12.2°	2/3 Type	8.4°	6.9°
	H	9.8°		6.7°	5.5°
	V	7.3°		5.0°	4.1°
Operation Temperature	-10°C - +50°C				

Dimensions

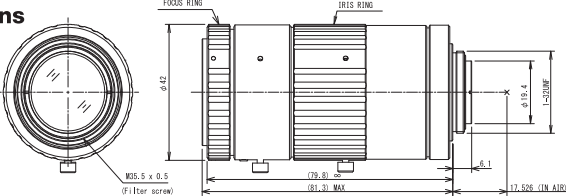

Pyramid Imaging Inc
 945 East 11th Avenue
 Tampa, FL 33605
<https://pyramidimaging.com>
Sales@pyramidimaging.com
 (813) 984-0125

Specification is subject to change without any notice
 *Described up to one decimal places.