

# T0928KRW



Pyramid Imaging

945 East 11th Avenue Tampa, FL 33605  
sales@pyramidimaging.com  
www.pyramidimaging.com  
813-786-3785

f = 0.95mm F2.8 Megapixel lens  
for 1/3 type Format Board Cameras, Fisheye, No Iris  
IR corrective

|   |   |                   |                    |                  |           |
|---|---|-------------------|--------------------|------------------|-----------|
| Model No.                                   | T0928KRW                                  | Effective         | Front              | φ 19mm           | 1/3 inch  |
| Focal Length                                | 0.95mm                                    | Lens Aperture     | Rear               | φ 5.4mm          |           |
| Max. Aperture Ratio                         | 1:2.8                                     | Distortion        |                    | -96.82%          | M12 P=0.5 |
| Image Size at 180°                          | φ 3.5                                     | Back Focal Length |                    | 3.38mm           |           |
| Operation Range                             | Iris                                      |                   | Flange Back Length | -                |           |
|   | Focus                                     | 0.05m - Inf.      | Mount              | M12 P=0.5mm      |           |
| Object Dimention at M.O.D.                  | 1/2.5 type                                | -                 | Dimensions         | φ 27mm x 27.52mm |           |
|   | 1/3 type                                  | -                 | Weight             | 19g              |           |
| Coating                                     | MgF2 Single Coat (All Surfaces λ = 546nm) |                   |                    |                  |           |
| Angle of View (Peripheral light amount 50%) | D   |                   | 1/3 type           | -                | 1/4 type  |
|   | H   |                   |                    | -                | 180°      |
|   | V   |                   | 180.°              |                  | 145.2°    |

## Dimensions

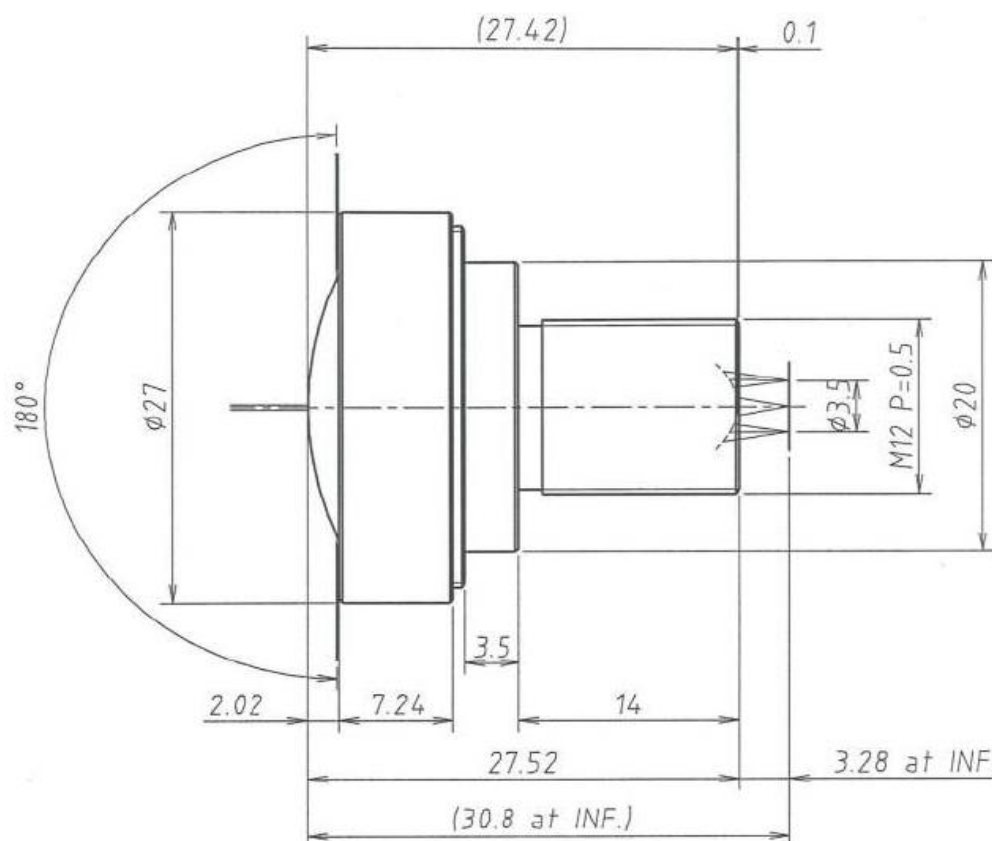

ImmerVision Enables Compatible.

Specification is subject to change without any notice.

04/02/2016