

**computar**

# M3528-MPW3

**f35mm F2.8**  
**For 2/3 type Cameras**  
**C-Mount**

Model No.	M3528-MPW3		Effective	Front	$\phi$ 17.8mm	
Focal Length	35mm		Lens Aperture	Rear	$\phi$ 11.8mm	
Max. Aperture Ratio	1:2.8		Back Focal Length		18.04mm	
Max. Image Format	8.8mm x 6.6mm( $\phi$ 11mm)		Flange Back Length		17.526mm	
Operation Range	Iris	F2.8 - 16.0	Mount		C-Mount	
	Focus	0.25m - inf.	Filter Size		M27 P=0.5mm	
Control	Iris	Manual	Dimensions		$\phi$ 29mm x 38.5mm	
	Focus	Manual	Weight		48g	
Object Dimension at M.O.D.	2/3 Type	33.8 x 45.1 mm				
	1/1.8 Type	27.4 x 36.6 mm				
	1/3 Type	18.4 x 24.6 mm				
Angle of View	D	2/3 type	17.9°	1/1.8 type	14.4°	1/3 type
	H		14.3°			
	V	10.8°	8.7°	5.9°		
Operating Temperature	-10°C - +50°C					

**2/3 type**

**C**

**Dimensions**

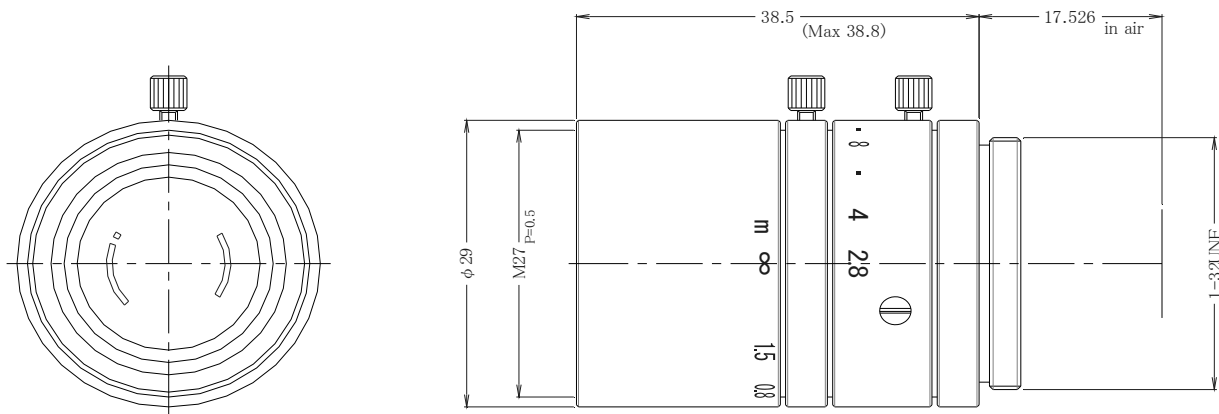

945 East 11<sup>th</sup> Avenue Tampa, FL 33605

Phone: (813) 984-0125

Contact: Sales@ pyramidimaging.com

<https://pyramidimaging.com>