

**Large FOV Telecentric**

Pyramid Imaging, Inc.  
945 East 11<sup>th</sup> Avenue  
Tampa, FL 33605  
www.pyramidimaging.com  
sales@pyramidimaging.com  
+1 813 984 0125

# VS-TLS 3.45 $\mu$ m SERIES

Supports 12MP 1.1"  
Front Unit-Rear Unit Reconfigurable Telecentric Lens



Fixed Magnification: 0.029 x ~ 0.1x / 6 models  
Max. FOV (Diagonal) 275mm

Supports 12MP 1.1"  
Front Unit-Rear Unit Reconfigurable Telecentric Lens

**Features**

- 3.45 $\mu$ m Resolution
- 6 models 0.029x~ 0.1x
- Magnification can be changed by changing the rear unit
- Fine tuning of WD is possible by the focus adjustment
- Distortion-less Design



**3 Magnifications available by changing the combination of front and rear units**

Changing the magnification is cost effective and easy to fine tune with the focus function

Wide range of FOV options are available by the combination with various camera sensor size.

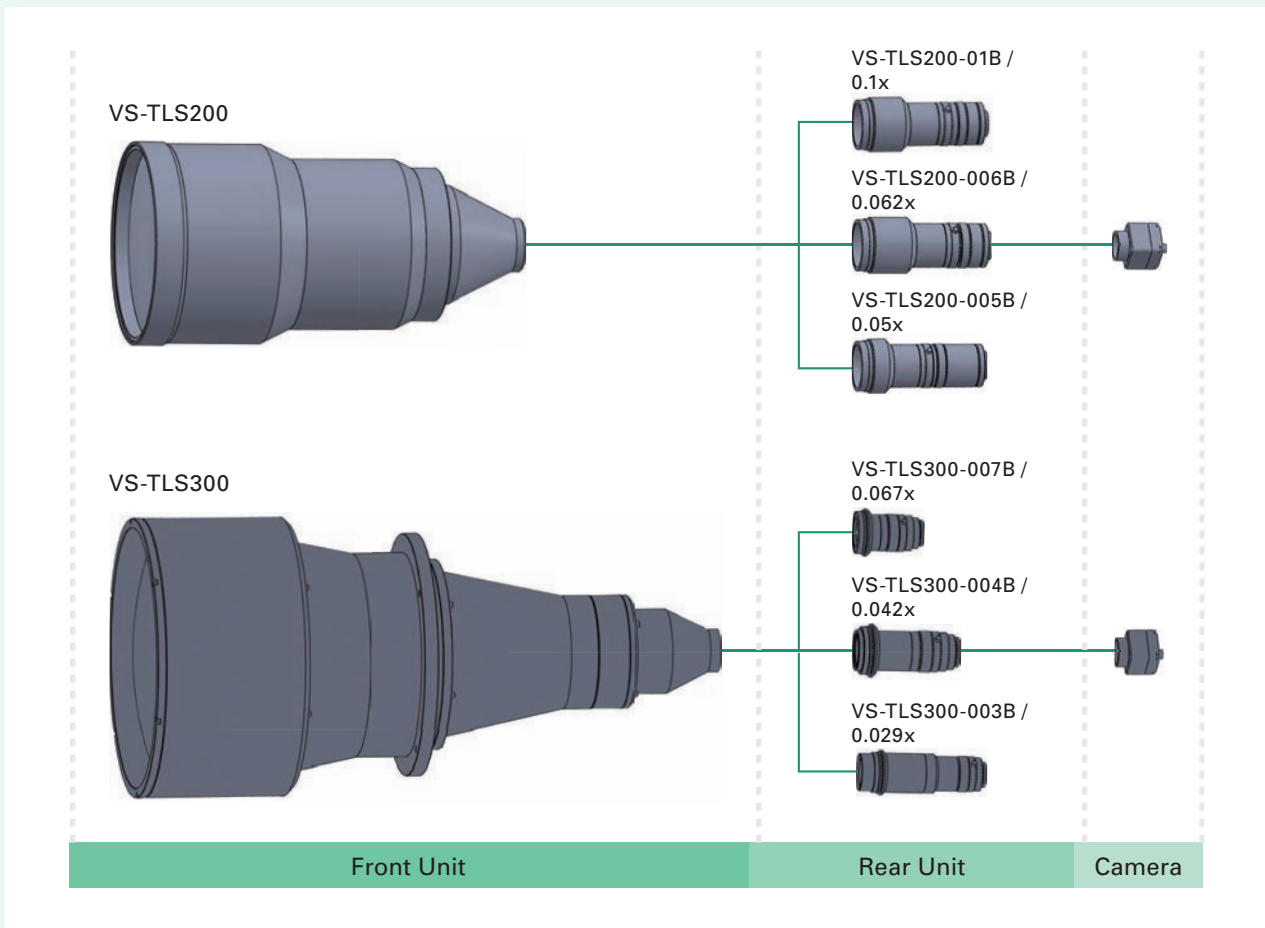



## Specifications

	Front Unit Model No.	Rear Unit Model No.	Opt. Mag.	TV Distortion	WD (mm)	O/I (mm)	Sensor Size (Max.)	Dimension
TLS200	VS-TLS200	VS-TLS200-01B	0.1	0.06%	301	825	1.1"	φ205(max.)xL=506.5 mm
	VS-TLS200	VS-TLS200-006B	0.062	0.05%	301	825	2/3"	φ205(max.)xL=506.5 mm
	VS-TLS200	VS-TLS200-005B	0.05	0.04%	301	825	1/1.8"	φ205(max.)xL=506.5 mm
TLS300	VS-TLS300	VS-TLS300-007B	0.067	-0.03%	500	1250	1.1"	φ300(max.)xL=732.5 mm
	VS-TLS300	VS-TLS300-004B	0.042	0.01%	500	1220	2/3"	φ300(max.)xL=702.5 mm
	VS-TLS300	VS-TLS300-003B	0.029	0.01%	500	1200	1/2"	φ300(max.)xL=682.5 mm

	Front Unit Model No.	Rear Unit Model No.	Opt. Mag.	FOV (mm)			
				1.1"	2/3"	1/1.8"	1/2"
TLS200	VS-TLS200	VS-TLS200-01B	0.1	141.0 x 103.0	84.0 x 71.0	71.0 x 54.0	64.0 x 48.0
	VS-TLS200	VS-TLS200-006B	0.062	-	135.5 x 114.5	114.5 x 87.1	103.2 x 77.4
	VS-TLS200	VS-TLS200-005B	0.05	-	-	142.0 x 108.0	128.0 x 96.0
TLS300	VS-TLS300	VS-TLS300-007B	0.067	210.4 x 153.7	125.4 x 106.0	106.0 x 80.6	95.5 x 71.6
	VS-TLS300	VS-TLS300-004B	0.042	-	200.0 x 169.0	169.0 x 128.6	152.4 x 114.3
	VS-TLS300	VS-TLS300-003B	0.029	-	-	-	220.7 x 165.5

Please refer another FOV table on page 4.

※VS-TLS300 and Rear Unit (007B-004B-003B) will be available around Sep, 2020.

**Collimated light or flat back light solutions are also available for the VS-TLS series.**

### Set-up Example

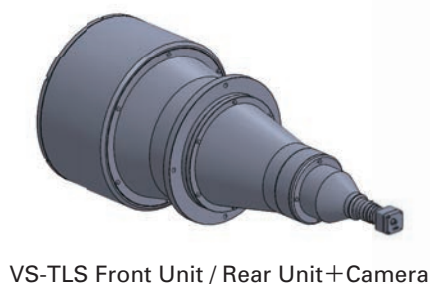
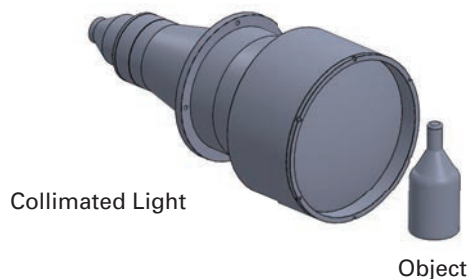

Sample Image : Glass Bottle



## FOV Table

FOV(H) (mm)	FOV(V) (mm)	Sensor Size	Opt. Mag.	Front Unit	Rear Unit
210.4	153.7	1/2"	0.029	VS-TLS300	VS-TLS300-003B
210.4	153.7	1.1"	0.067	VS-TLS300	VS-TLS300-007B
200.0	169.0	2/3"	0.042	VS-TLS300	VS-TLS300-004B
169.0	128.6	1/1.8"	0.042	VS-TLS300	VS-TLS300-004B
168.1	168.1	1"	0.067	VS-TLS300	VS-TLS300-007B
165.5	124.1	1/3"	0.029	VS-TLS300	VS-TLS300-003B
152.4	114.3	1/2"	0.042	VS-TLS300	VS-TLS300-004B
142.0	108.0	1/1.8"	0.05	VS-TLS200	VS-TLS200-005B
141.0	103.0	1.1"	0.1	VS-TLS200	VS-TLS200-01B
135.5	114.5	2/3"	0.062	VS-TLS200	VS-TLS200-006B
128.0	96.0	1/2"	0.05	VS-TLS200	VS-TLS200-005B
125.4	106.0	2/3"	0.067	VS-TLS300	VS-TLS300-007B
114.5	87.1	1/1.8"	0.062	VS-TLS200	VS-TLS200-006B
114.3	85.7	1/3"	0.042	VS-TLS300	VS-TLS300-004B
112.6	112.6	1"	0.1	VS-TLS200	VS-TLS200-01B
106.0	80.6	1/1.8"	0.067	VS-TLS300	VS-TLS300-007B
103.2	77.4	1/2"	0.062	VS-TLS200	VS-TLS200-006B
96.0	72.0	1/3"	0.05	VS-TLS200	VS-TLS200-005B
95.5	71.6	1/2"	0.067	VS-TLS300	VS-TLS300-007B
84.0	71.0	2/3"	0.1	VS-TLS200	VS-TLS200-01B
77.4	58.1	1/3"	0.062	VS-TLS200	VS-TLS200-006B
71.6	53.7	1/3"	0.067	VS-TLS300	VS-TLS300-007B
71.0	54.0	1/1.8"	0.1	VS-TLS200	VS-TLS200-01B
64.0	48.0	1/2"	0.1	VS-TLS200	VS-TLS200-01B
48.0	36.0	1/3"	0.1	VS-TLS200	VS-TLS200-01B

Actual FOV may be slightly different from the above table due to camera sensor size

## Applications



Pyramid Imaging, Inc.  
945 East 11<sup>th</sup> Avenue  
Tampa, FL 33605  
www.pyramidimaging.com  
sales@pyramidimaging.com  
+1 813 984 0125

Glass Bottles



Automobile Parts

## International Sales Offices

<b>VST Europe (Winterthur)</b> TEL: +41-52-508-0109	<b>VST Poland(Warsaw)</b> TEL: +48-22-492-6683	<b>VST Vietnam (Hanoi)</b> TEL: +84-24-6327-8566	<b>VST Shenzhen (Shenzhen)</b> TEL: +86-755-8273-1420	<b>VST Taiwan (Hsinchu)</b> TEL: +886-3-668-1381(ext.9)	<b>VST America (Santa Clara)</b> TEL: +1-408-753-5115
<b>VST Europe (Amsterdam)</b> TEL: +31-20-305-1310	<b>VST Russia(Moscow)</b> TEL: +7-926-585-4721	<b>VST India(Bengaluru)</b> TEL: +91-80888-31893	<b>VST Shenzhen (Shanghai)</b> TEL: +86-21-6255-0725	<b>VST Taiwan (Kaohsiung)</b> TEL: +886-7-586-8957	<b>VST Mexico(Guadalajara)</b> TEL: +52-33-3002-4076
<b>VST Europe (Paris)</b> TEL: +33-1-8288-5798	<b>VST Thailand (Bangkok)</b> TEL: +662-260-0912	<b>VST Korea (Seoul)</b> TEL: +82-2-2183-3848	<b>VST Taiwan (Taipei)</b> TEL: +886-2-2531-2036		