

SCALE 1:1

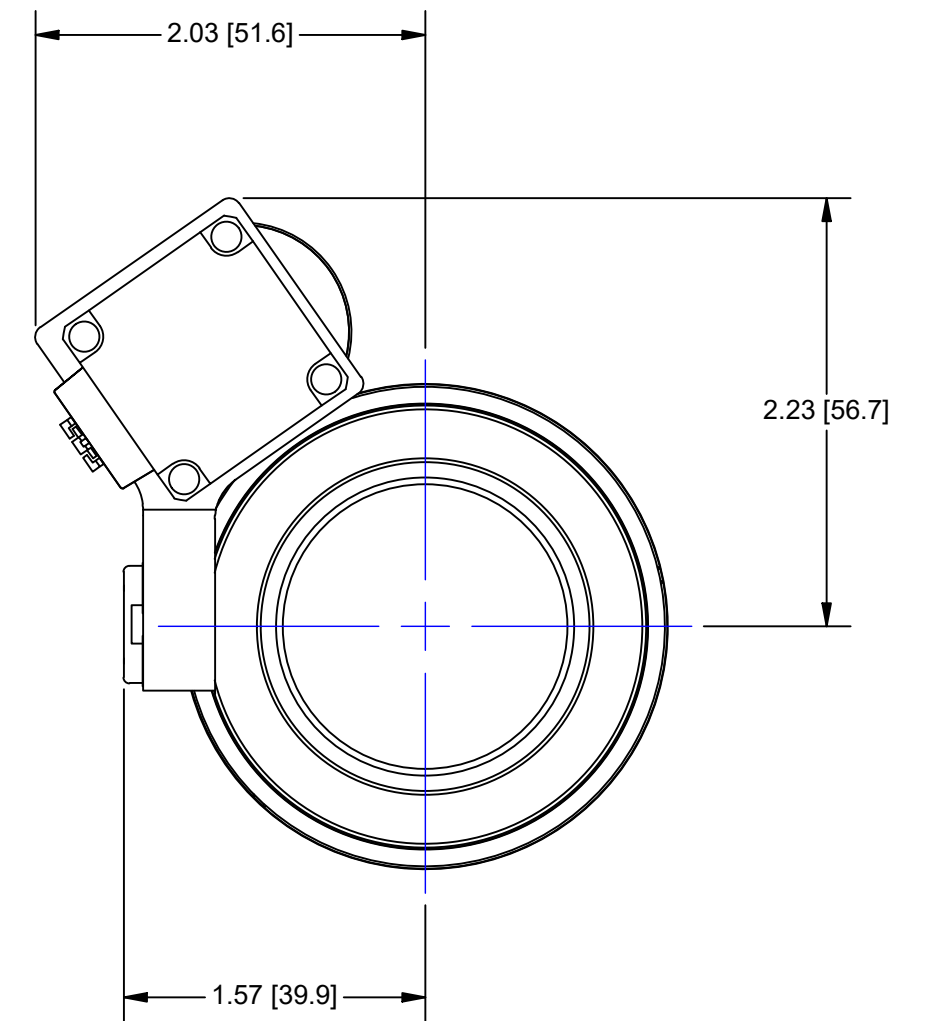
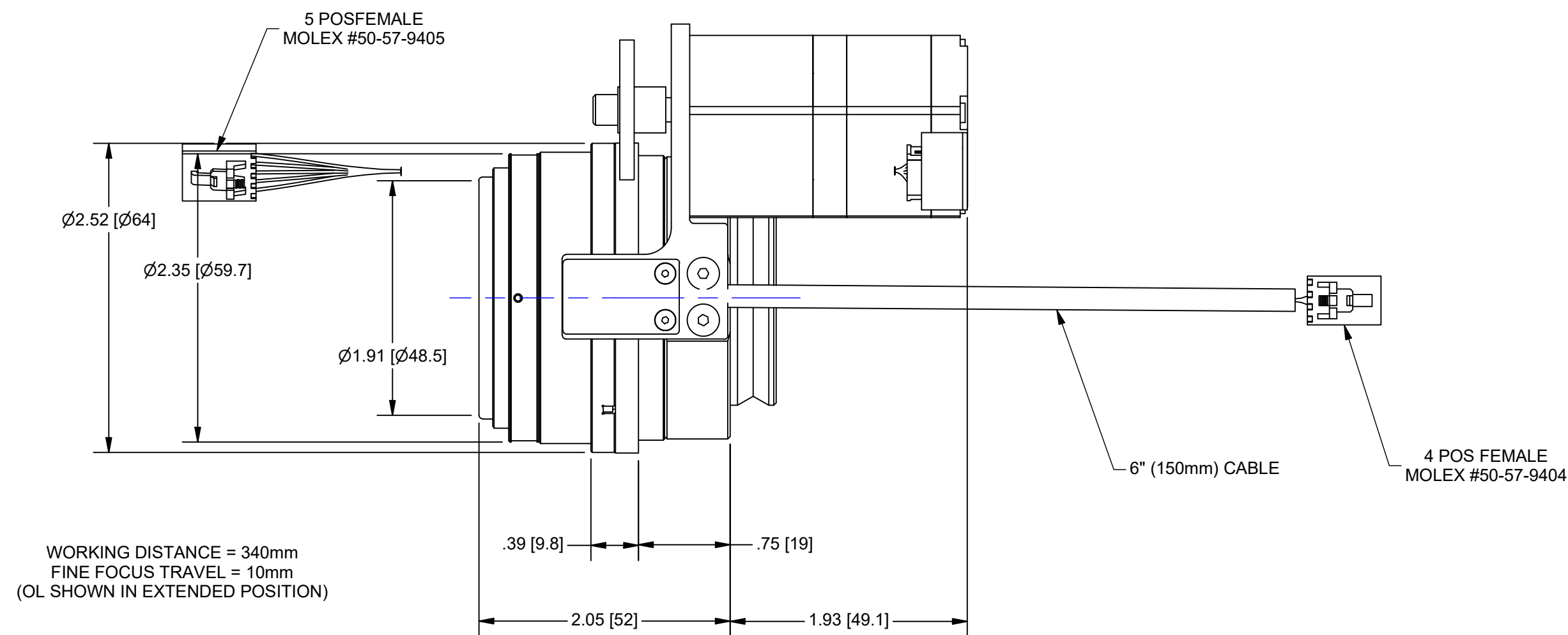

5Φ MOTOR AND HALL EFFECT CABLE INFORMATION:

- FOCUS / HE CABLE LENGTH = 0.15m
- USE NAVITAR #1-40170 (1.8m), 1-40289 (1.2m), 1-40290 (0.6m) TO CONNECT TO NAVITAR 5Φ PHASE CONTROLLERS (1-40167, 1-40168, 1-40169)

FF MOTOR
5 POSITION FEMALE
CONNECTOR
(MOLEX #50-57-9405)

HE SENSOR
4 POSITION FEMALE
CONNECTOR
(MOLEX #50-57-9404)

5Φ FF MOTOR PINOUT
PIN 1 = MOTOR 1 (BLUE)
PIN 2 = MOTOR 2 (RED)
PIN 3 = MOTOR 3 (ORANGE)
PIN 4 = MOTOR 4 (GREEN)
PIN 5 = MOTOR 5 (BLACK)

4 PIN HE SENSOR PINOUT
PIN 1 = COMMON
PIN 2 = FAR LIMIT
PIN 3 = +5VDC
PIN 4 = NEAR LIMIT



945 East 11th Avenue Tampa, FL 33605

Phone: (813) 984-0125

Contact: Sales@pyramidimaging.com

<https://pyramidimaging.com>

OUTLINE



MTR FF, 5Φ, 0.25X LENS
ATTACHMENT

UNLESS OTHERWISE SPECIFIED DIMENSIONS ARE IN INCHES (MM) AND INCLUDE CHEMICALLY APPLIED OR PLATED FINISHES		PROPRIETARY AND CONFIDENTIAL THE INFORMATION CONTAINED IN THIS DRAWING IS THE SOLE PROPERTY OF NAVITAR. ANY REPRODUCTION IN PART OR AS A WHOLE WITHOUT THE WRITTEN PERMISSION OF NAVITAR IS PROHIBITED.		NAVITAR ROCHESTER, NEW YORK	
SCALE:	2:1	0.0 inch 1.0		PART NUMBER 1-81201M5	
WEIGHT:	0.82 lbmass	0.0 mm 25.0			
DR BY:	J. WILLIAMSON	DO NOT SCALE DRAWING		SIZE	C
CH BY:	PB	⊕		REV	A
PROJECT #:	E3576	DATE DR: 11/29/2017			