

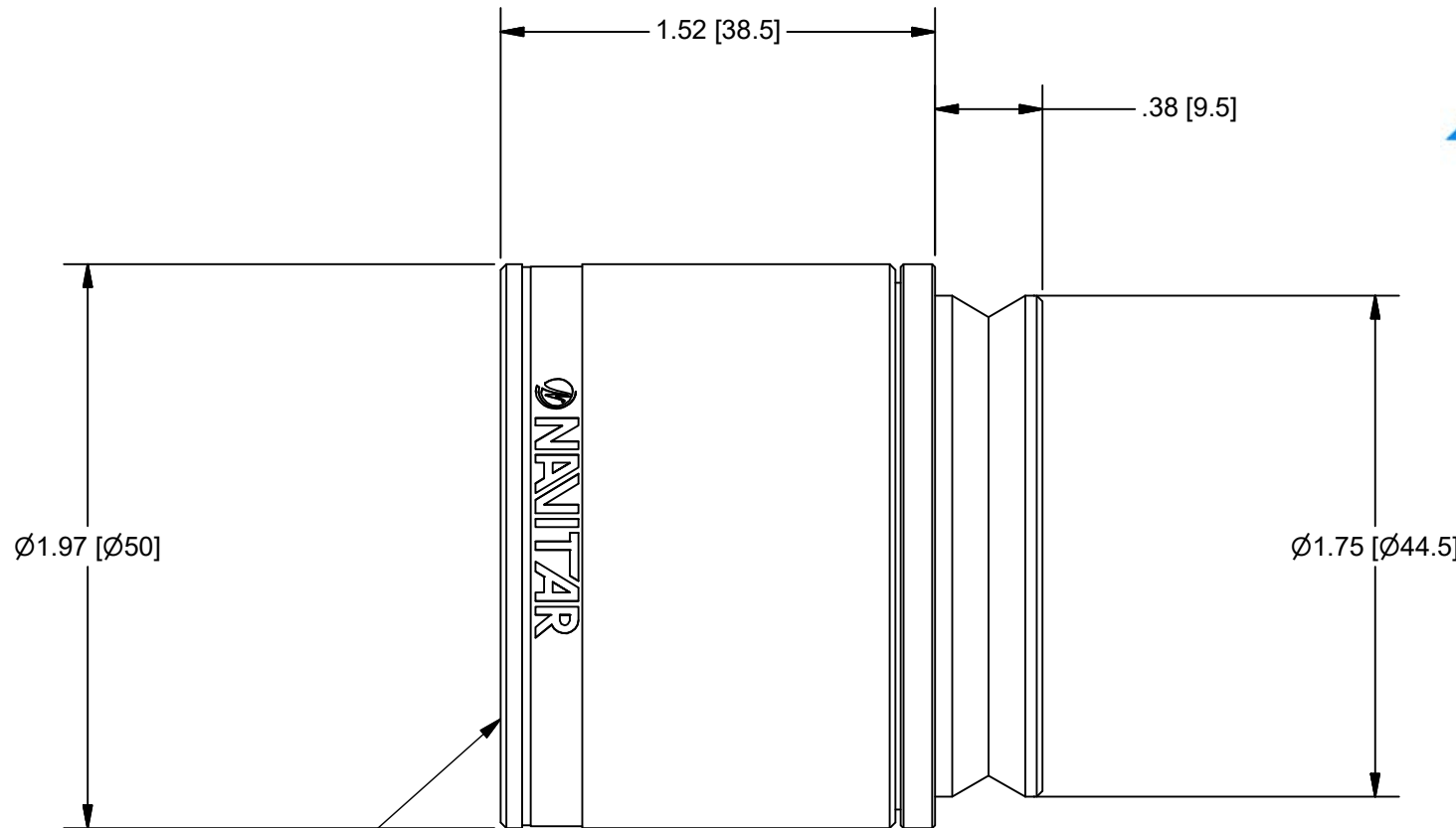

Pyramid Imaging

945 East 11th Avenue Tampa, FL 33605
 sales@pyramidimaging.com
 www.pyramidimaging.com
 813-786-3785



M46x0.75 INTERNAL
 THREAD

OUTLINE

0.5X LENS ATTACHMENT FOR RESOLV 4K

FOCAL LENGTH: 200.0mm
OBJECT COVERAGE: 50.0mm - 7.1mm (LOW - HIGH MAG)
DISTORTION: -1.58% - -0.031%
PUPIL Ø: 6.585mm - 19.0mm
OBJ NA: 0.0165 - .0474
WAVELENGTH: 430 - 650nm VIS
 430 - 1000nm VNIR
 900 - 1700nm SWIR
TRANSMISSION: 97.2% (445 - 655nm VIS)
 95.8% (445 - 950nm VNIR)

UNLESS OTHERWISE SPECIFIED
 DIMENSIONS ARE IN INCHES
 AND INCLUDE CHEMICALLY
 APPLIED OR PLATED FINISHES

PROPRIETARY AND CONFIDENTIAL

THE INFORMATION CONTAINED IN THIS DRAWING IS THE SOLE PROPERTY OF
 NAVITAR. ANY REPRODUCTION IN PART OR AS A WHOLE WITHOUT THE WRITTEN
 PERMISSION OF NAVITAR IS PROHIBITED.

SCALE:	1.5:1
WEIGHT:	0.42 lbmass
DR BY:	J. WILLIAMSON
CH BY:	DEROSA
PROJECT #:	E3526
DATE DR:	5/3/2017



LENS, 0.5X LENS ATTACHMENT

DO NOT SCALE DRAWING	SIZE	PART NUMBER	REV
SHEET 2 OF 2	A	1-81202	A