

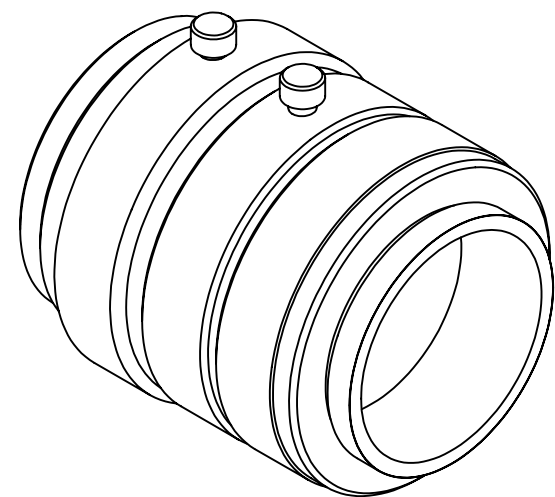

# Pyramid Imaging

945 East 11th Avenue  
 Tampa, FL 33605  
 sales@pyramidimaging.com  
 www.pyramidimaging.com  
 813-786-3785

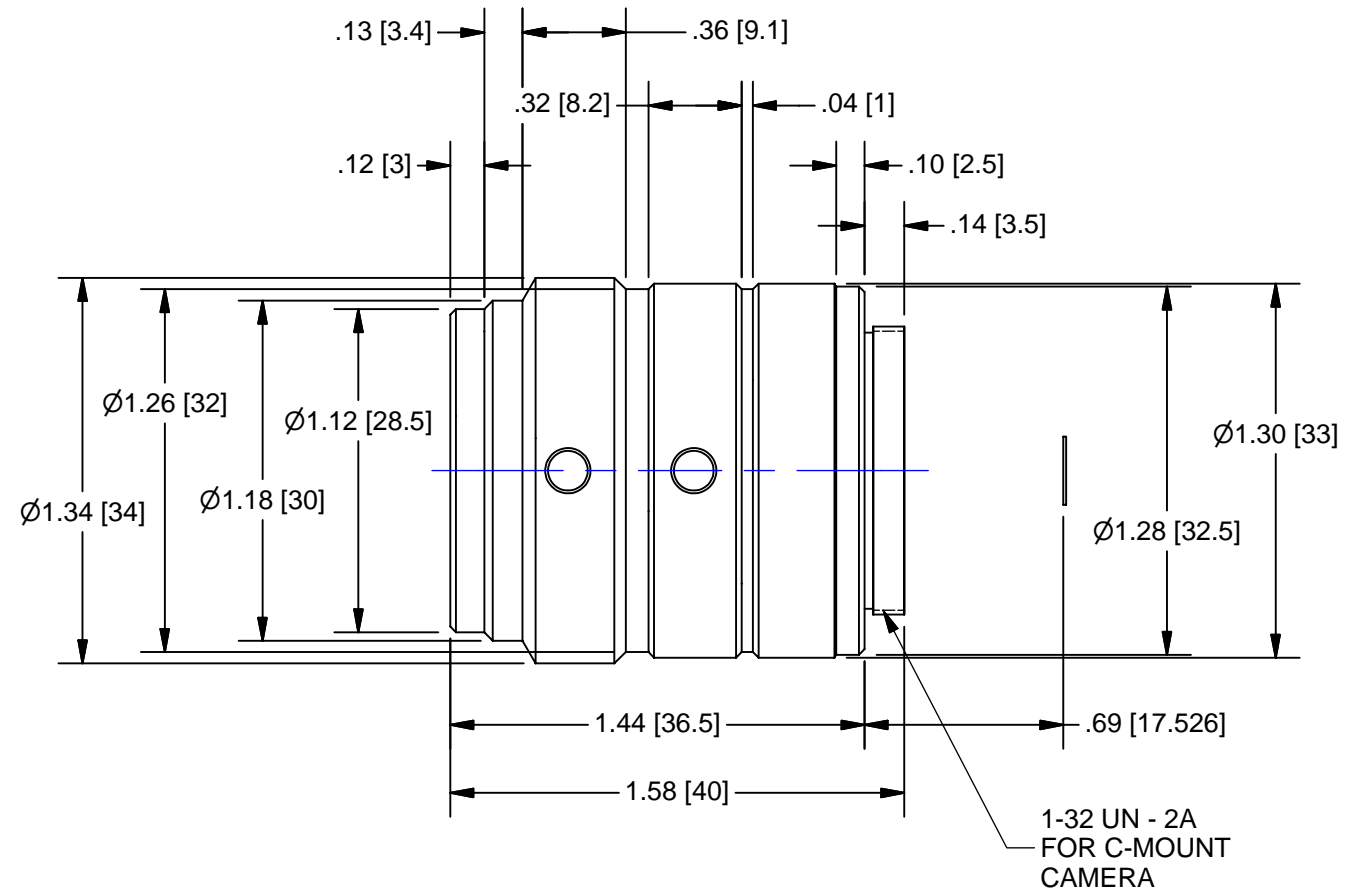
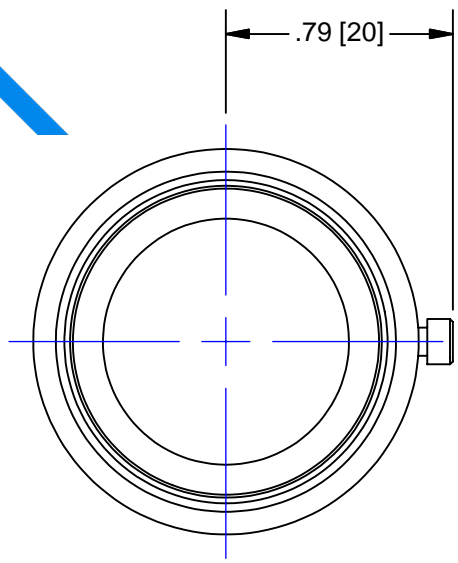

## OUTLINE

Lens Specification - NMV - 35M23				
Specification		Value	1/2"	1/3"
Focal Length		f = 35mm		
Max. Diameter (Ratio)		F = 1:1.4 ~ 16		
Element		4 Groups 7 Elements		
Picture Size		6.6 x 8.8mm	4.8 x 6.4mm	4.8 x 3.6mm
Angle	Vertical	10.8 deg.	7.85 deg.	5.89 deg.
	Horizontal	14.4 deg.	10.5 deg.	7.85 deg.
	Diagonal	17.9 deg.	13.1 deg.	9.81 deg.
Distortion (TV)		- 0.05%	-	
Shooting Range at	Vertical	35.8mm	26.0mm	19.5mm
	Horizontal	47.9mm	34.7mm	26.0mm
	Diagonal	60.0mm	43.5mm	32.5mm
Minimum Focus Distance		0.2m		
Flange Back Focus		17.526mm in air		
Back Focus		20.1mm in air		
Filter Screw Size		M27.0 x 0.5		
Effective Diameter	Front	21.5mm		
	Rear	11.7mm		
Mount		C-Mount		
Exit Pupil		- 38.7mm		
Temperature Range		-10 ~ +45 deg. C		
Strong Temperature Range		-40 ~ +60 deg. C		
Resolution	Center	100 Line/mm		
	Corner	80 Line/mm		
Weight				

UNLESS OTHERWISE SPECIFIED DIMENSIONS ARE IN INCHES AND INCLUDE CHEMICALLY APPLIED OR PLATED FINISHES	THE CONTENTS OF THIS DOCUMENT ARE PROPRIETARY TO NAVITAR, ITS USE IS AUTHORIZED ONLY FOR RESPONDING TO REQUEST FOR QUOTATION OR PERFORMANCE OF WORK FOR NAVITAR	 ROCHESTER, NEW YORK		
	SCALE: 1.5:1			WEIGHT: See Table
DR: BE	CH:	 DO NOT SCALE DRAWING		
PROJECT #: E2338	DATE DR: 7/11/2007			
		SIZE <b>B</b>	<b>NMV - 35M23</b> SHEET 1 OF 1	REV <b>A</b>

LENS, 35mm FL, f/2.0, 2/3" MEGAPIXEL