

Pyramid Imaging

945 East 11th Avenue
 Tampa, FL 33605
 sales@pyramidimaging.com
 www.pyramidimaging.com
 813-786-3785

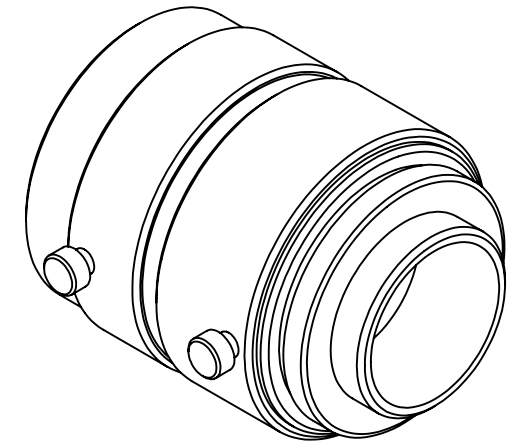
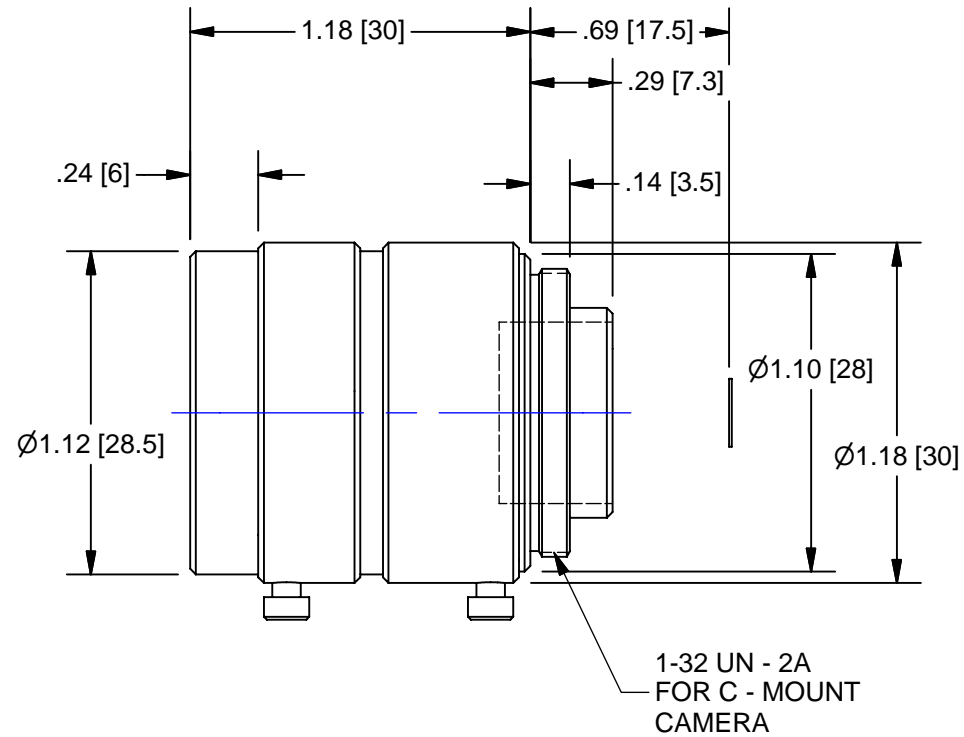
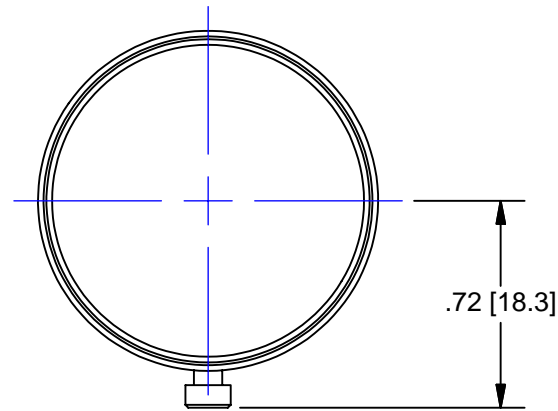

Lens Specifications - NMV - 8			
Specifications	Value	1/2"	1/3"
Focal Length	f = 8mm		
Maximum diameter (Ratio)	F = 1.4:1 ~ 16 ~ Close		
Element	6 gp. 7 Element		
Picture Size	6.6 x 8.8mm	4.8 x 6.4mm	3.6 x 4.8 mm
Angle - Vertical	47.7 deg.	34.6 deg.	28.6 deg.
Horizontal	64.2 deg.	46.2 deg.	34.5 deg.
Diagonal	81.3 deg.	58.1 deg.	43.3 deg.
Distortion	-6.2%	-2.5%	-1.3%
Shooting Range - Vertical	184mm	129.3mm	95.5mm
At Minimum - Horizontal	260mm	177.5mm	129.3mm
Focus Distance - Diagonal	356mm	231.0mm	165.1mm
Minimum Focus Distance	0.1m		
Flange Back	17.526mm in air		
Back Focus	11.3mm in air		
Filter Screw Size	m27.0 X 0.5		
Effective Diameter - Front	17.4mm dia.		
- Rear	11.1mm dia.		
Mount	C-Mount		
Exit Pupil	-30.2mm dia.		
Temperature Range	- 10 ~ + 45 deg. C		
Strong Temperature Range	- 40 ~ + 60 deg. C		
Resolution - Center	100 Line/mm		
- Corner	40 Line/mm		

OUTLINE



LENS, 8.0mm FL, , 2/3", f/1.4

UNLESS OTHERWISE SPECIFIED DIMENSIONS ARE IN INCHES AND INCLUDE CHEMICALLY APPLIED OR PLATED FINISHES		THE CONTENTS OF THIS DOCUMENT ARE PROPRIETARY TO NAVITAR. ITS USE IS AUTHORIZED ONLY FOR RESPONDING TO REQUEST FOR QUOTATION OR PERFORMANCE OF WORK FOR NAVITAR	
SCALE:	1.5:1		
WEIGHT:	See Table		
DR:	BE		
CH:		DO NOT SCALE DRAWING	
PROJECT #:	E2338	SIZE	B
DATE DR:	7/13/2007		NMV - 8
			SHEET 1 OF 1
			REV A