

#### sensor information

sensor	ams (CMOSIS) CMV20000
resolution	5120 × 3840 px
exposure time	0,19 ... 1000 ms
pixel size	6.4 × 6.4 μm
shutter type	Global shutter
sensor type	35 mm CMOS

#### acquisition formats

image formats, interface frame rate max.	Full Frame, 5120 × 3840 px, max. 6 fps
image formats, acquisition frame rate max. (Burst Mode)	Full Frame, 5120 × 3840 px, max. 16 fps
pixel formats	Mono8 Mono12

#### image preprocessing

analog controls	Gain (0 ... 12 dB) Offset (0 ... 255 LSB 12 Bit)
color models	Mono
image processing	VisualApplets 2.x

#### interfaces and connectors

data interface	Gigabit Ethernet, Transfer rate 1000 Mbits/sec, Connector: 8P8C Modular Jack (RJ45), screwable type
process interface	M8 / 8 pins (2x)
power supply	M8 / 8 pins

#### mechanical data

lens mount	M58-mount (F-mount, M42, C-mount via adapter)
width	60 mm
height	60 mm
depth	54,25 mm
weight	≤ 290 g (M58-mount)

#### mechanical data

material	housing: aluminum
----------	-------------------

#### electrical data

voltage supply range +Vs	12 ... 24 V DC (external power supply) 36 ... 57 V DC (Power over Ethernet)
power consumption	approx. 6,5 W @ 24 VDC approx. 6,5 W @ 48 VDC (PoE)

#### non-volatile memory

flash memory size	128 kB
-------------------	--------

#### environmental conditions

operating temperature	+5 ... +50 °C
humidity	10 ... 90 % (non-condensing)
protection class	IP 40

#### conformity

conformity	CE RoHS EAC
------------	-------------------

# LXG-200M.P

Gigabit Ethernet, 20 Megapixel, Monochrome

Article number: 11155111

## dimension drawing

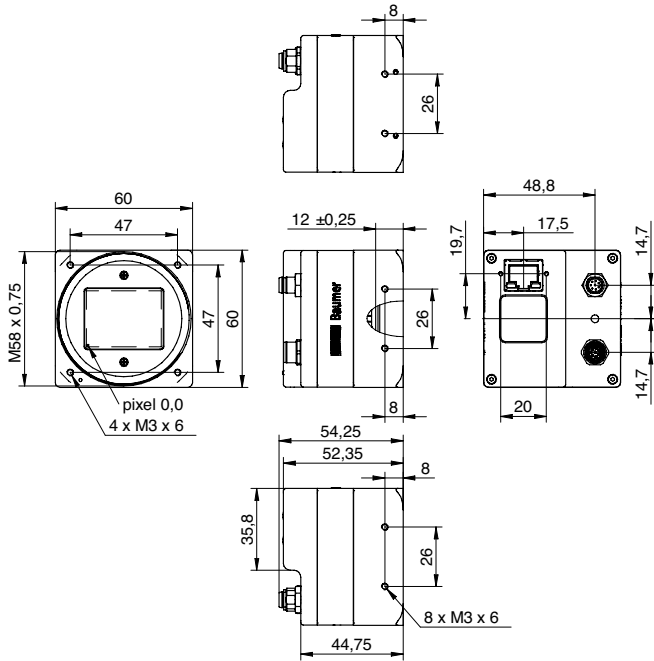

945 East 11<sup>th</sup> Avenue Tampa, FL 33605

Phone: (813) 984-0125

Contact: Sales@pyramidimaging.com

<https://pyramidimaging.com>