

sensor information

sensor	ams (CMOSIS) CMV12000
resolution	4096 × 3072 px
exposure time	0,06 ... 1000 ms
pixel size	5.5 × 5.5 μm
shutter type	Global shutter
sensor type	APS-C CMOS

acquisition formats

image formats, interface frame rate max.	Full Frame, 4096 × 3072 px, max. 9 fps
image formats, acquisition frame rate max. (Burst Mode)	Full Frame, 4096 × 3072 px, max. 25 fps
pixel formats	Mono8 Mono12

image preprocessing

analog controls	Gain (0 ... 12 dB) Offset (0 ... 255 LSB 12 Bit)
color models	Mono
image processing	VisualApplets 2.x

interfaces and connectors

data interface	Gigabit Ethernet, Transfer rate 1000 Mbits/sec, Connector: 8P8C Modular Jack (RJ45), screwable type
process interface	M8 / 8 pins (2x)
power supply	M8 / 8 pins

mechanical data

lens mount	M58-mount (F-mount, M42, C-mount via adapter)
width	60 mm
height	60 mm
depth	54,25 mm
weight	≤ 290 g (M58-mount)

mechanical data

material	housing: aluminum
----------	-------------------

electrical data

voltage supply	12 ... 24 V DC (external power supply)
range +Vs	36 ... 57 V DC (Power over Ethernet)
power consumption	approx. 7,0 W @ 24 VDC approx. 7,4 W @ 48 VDC (PoE)

non-volatile memory

flash memory size	128 kB
-------------------	--------

environmental conditions

operating temperature	+5 ... +50 °C
humidity	10 ... 90 % (non-condensing)
protection class	IP 40

conformity

conformity	CE RoHS EAC
------------	-------------------

LXG-120M.P

Gigabit Ethernet, 12 Megapixel, Monochrome

Article number: 11155110

dimension drawing

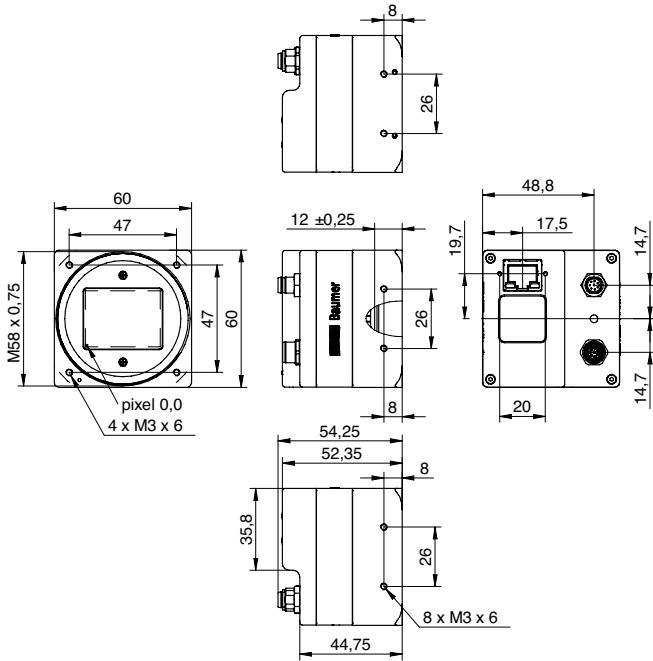

945 East 11th Avenue Tampa, FL 33605

Phone: (813) 984-0125

Contact: Sales@pyramidimaging.com

<https://pyramidimaging.com>