

T0812FICS-3

8mm F1.2
for 1/3 type Cameras, Fixed-focal Manual Iris
CS-Mount

1/3
type

Model No.	T0812FICS-3		Effective	Front	Ø15.0mm
Focal Length	8mm		Lens Aperture	Rear	Ø8.8mm
Max. Aperture Ratio	1:1.2		Back Focal Length	7.5mm	
Max. Image Format	4.8mm x 3.6mm(Ø6mm)		Flange Back Length	12.5mm	
Operation Range	Iris	F1.2 - F16C	Mount	CS-Mount	
	Focus	0.2m - Inf.	Filter Size	---	
Control	Iris	Manual	Dimensions	Ø34.5mm x 33mm	
	Focus	Manual	Weight	37g	
Object Dimension at M.O.D.	12.5cm x 9.2cm				
Angle of View	D	1/3 type	43.5°	1/4 type	32.4°
	H			25.9°	
	V			16.4°	
Operating Temperature	-20°C - +50°C				

M.O.D : Minimum Object Distance

Dimensions

CS

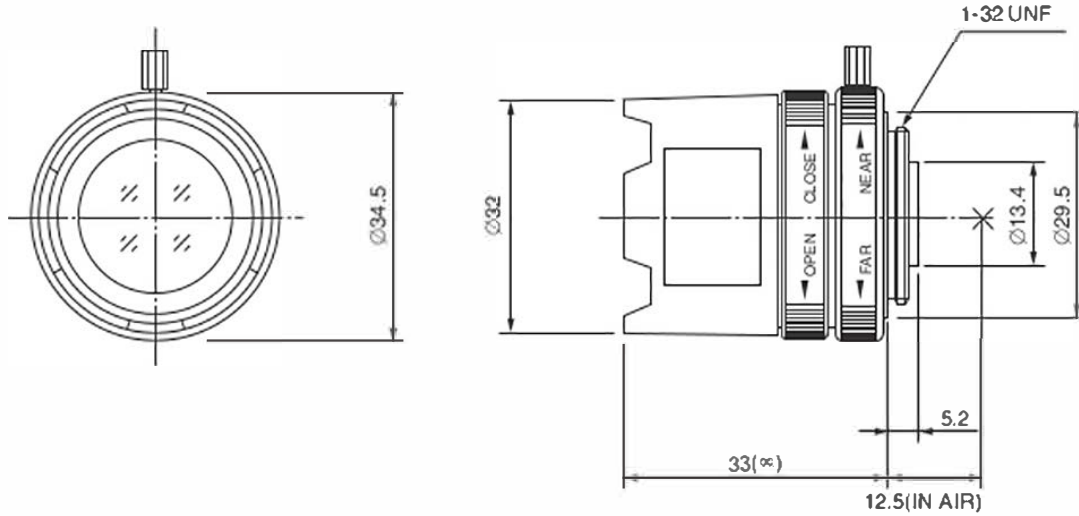

945 East 11th Avenue Tampa, FL 33605

Phone: (813) 984-0125

Contact: Sales@ pyramidimaging.com

<https://pyramidimaging.com>

